

## TRUE AIRSPEED INDICATOR - MAINTENANCE PRACTICES

### 1. General

- A. The true airspeed indicator, located in the upper left corner of the pilot's instrument panel, is equipped with a conversion ring, which may be rotated until pressure altitude is aligned with outside air temperature. Then, airspeed indicated on the instrument is read as true airspeed on the adjustable ring. An optional right located airspeed (not true airspeed) indicator is also available. Maintenance practices for the right airspeed indicator are the same as for the true airspeed indicator, except the retainer (9) and ring (10) on the true airspeed indicator are replaced by a faceplate on the right airspeed indicator installation.

### 2. True Airspeed Indicator Removal/Installation

- A. Remove True Airspeed Indicator (Refer to Figure 201).
- (1) Remove screws and washers securing removable flight panel (7) and slide flight panel (7) aft to gain access to back of true airspeed indicator (6).
  - (2) Loosen clamps (1) and (4).
  - (3) Disconnect, cap off, and identify lines (2) and (3) from fittings (5), located on back of true airspeed indicator (6).
  - (4) Remove screws (8) securing retainer (9), true airspeed ring (10), spacer (11), and true airspeed indicator (6) to flight panel (7).
  - (5) Remove true airspeed indicator (6), retainer (9), true airspeed ring (10), and spacer (11).
  - (6) Remove fittings (5) and plug openings in back of true airspeed indicator (6) to avoid possible contamination of instrument.
- B. Install True Airspeed Indicator (Refer to Figure 201).
- (1) Remove plugs in back of true airspeed indicator (6) and install fittings (5).
  - (2) Position spacer (11) of adequate thickness required on true airspeed indicator (6).  
**NOTE: Use spacers (11) as required to provide adequate friction on true airspeed ring (10).**
  - (3) Position true airspeed indicator (6) in its appropriate opening in flight panel (7) by inserting it up through forward side of flight panel.
  - (4) Position true airspeed ring (10) and retainer (9) on aft side of flight panel (7).
  - (5) Install screws (8) securing true airspeed indicator (6), true airspeed ring (10), and retainer (9) and spacer (11) to flight panel (7).  
**NOTE: Do not overtighten screws (8) to the extent that true airspeed ring (10) and retainer (11) cannot be adjusted.**
  - (6) Connect lines (2) and (3) to fittings (5), located on back of true airspeed indicator (6).
  - (7) Tighten clamps (1) and (4).
  - (8) Adjust true airspeed indicator in accordance with procedures in True Airspeed Indicator Adjustment.

### 3. True Airspeed Indicator Adjustment

- A. Adjust True Airspeed Indicator (Refer to Figure 201).
- (1) Loosen screws (8) securing true airspeed indicator (6), true airspeed ring (10), and
  - (2) retainer (11) to flight panel (7). Rotate true airspeed ring (10) until 110 knots on true airspeed ring aligns with 110 knots on face of true airspeed indicator (6).
  - (3) Holding this setting, move retainer (9) until 15°C aligns with zero pressure altitude; tighten screws (8).

Figure 201 : Sheet 1 : True Airspeed Indicator Installation

A22299

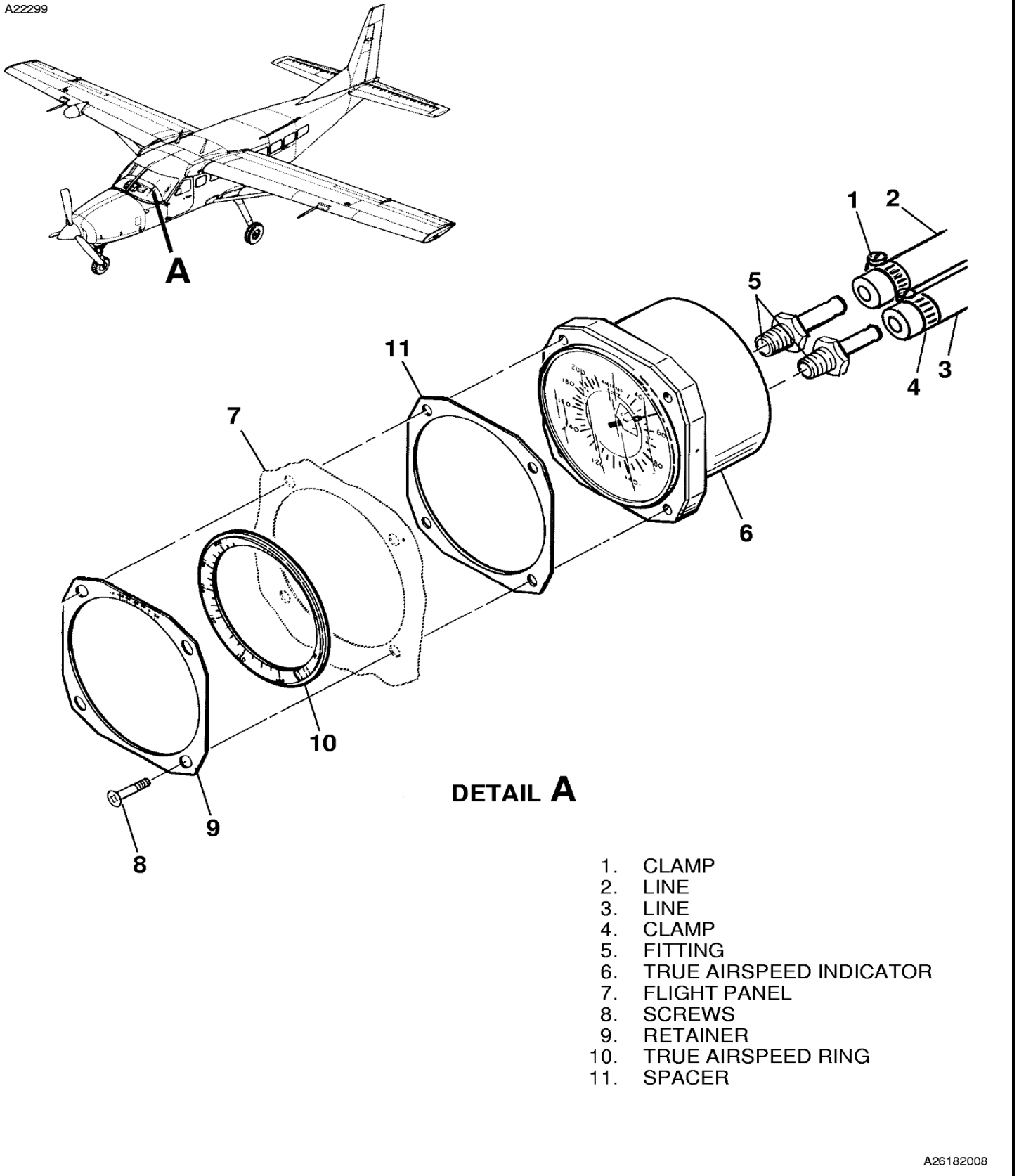

A26182008